

GULF MOUNT MANAGEMENT COMPANY  
VOL. 414, PG. 187  
(869.30 AC.)

WILLIAM R. REDING  
SURVEY NO. 7  
ABSTRACT NO. 384

SCALE 1" = 200'

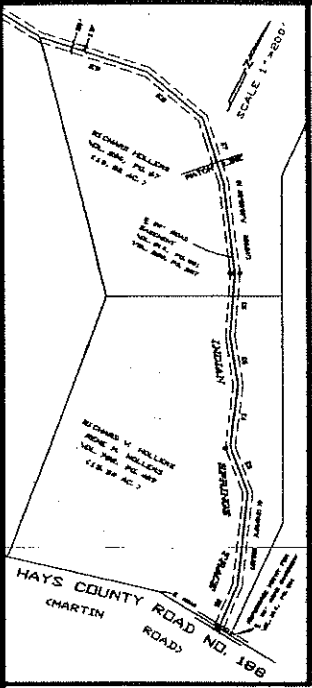

CECIL H. HALE  
VOL. 241, PG. 847  
(123.39 AC.)

WILLIAM R. MARTIN SURVEY NO. 2  
ABSTRACT NO. 748

LOT 1A  
36.672 AC.

LOT 2A  
22.172 AC.

LOT 3  
22.90 AC.

EDWARD M. NORRIS  
MARY K. NORRIS  
VOL. 310, PG. 44  
(110.10 AC.)

LOT 4  
17.08 AC.

ROBERT ANTHONY FERNANDEZ  
VOL. 343, PG. 612  
(11.2 AC.)  
BEING A PORTION OF 110.10 ACRE NORRIS  
TRACT (VOL. 310, PG. 44)

RICHARD HOLLERS  
VOL. 286, PG. 67  
(10.39 AC.)

INDIAN SPRINGS TRACT  
(30' R.O.W.)

**LEGEND**

- ( ) RECORD INFORMATION
- IRON ROD FOUND
- IRON ROD SET
- - - WIRE FENCE
- - - OVERHEAD UTILITY LINE
- UTILITY POLE
- GUY ANCHOR

TRACT 3  
VOL. 392, PG. 149  
(9.64 AC.)

TRACT 4  
VOL. 382, PG. 87  
(10.94 AC.)

TRACT 5  
VOL. 392, PG. 112  
(10.201 AC.)

TRACT 6  
VOL. 395, PG. 494  
(10.227 AC.)

TRACT 7  
VOL. 601, PG. 886  
(11.01 AC.)

TRACT 8  
VOL. 601, PG. 886  
(11.01 AC.)

TRACT 9  
VOL. 601, PG. 886  
(11.01 AC.)

PIONEER RANCH NO. 2  
(UNRECORDED SUBDIVISION)

L. TONNETT BYRD  
VOL. 250, PG. 991  
(257.98 AC.)

**MEASURED BOUNDARY COURSES**

LINE	BEARING	DISTANCE
L 3	N 39°21'50"W	218.82'
L 4	N 07°39'51"W	148.29'
L 5	N 06°00'05"E	125.09'
L 6	N 04°14'53"E	143.01'
L 7	N 17°17'30"W	98.83'
L 8	N 24°36'37"E	185.78'
L 9	N 76°49'57"W	176.88'
L 10	N 09°50'17"E	266.30'

**RECORD BOUNDARY COURSES**

LINE	BEARING	DISTANCE
L 3	N 39°19'E	218.88'
L 4	N 08°01'W	148.48'
L 5	N 06°10'E	136.61'
L 6	N 04°16'E	143.41'
L 7	N 17°20'W	98.80'
L 8	N 24°47'E	186.49'
L 9	N 76°44'W	177.10'
L 10	N 09°56'E	266.40'

**RECORD & ROAD EASEMENT COURSES**

LINE	BEARING	DISTANCE
E 1	N 85°17'W	41.00'
E 2	N 01°39'W	151.31'
E 3	N 47°13'W	153.89'
E 4	N 18°30'W	191.26'
E 5	N 35°07'W	155.82'
E 6	N 21°16'W	193.65'
E 7	N 44°08'W	210.95'
E 8	N 76°44'W	225.23'
E 9	S 81°31'W	305.32'

TOTAL NO. OF LOTS: 2  
TOTAL ACREAGE: 59.84 ACRES  
PROPOSED LAND USE: RESIDENTIAL  
AVERAGE LOT AREA: 29.42  
NO. OF LOTS LARGER THAN 20 AC.: 2

ELECTRICITY SERVICE: FEDERNALES ELECTRIC COOPERATIVE, INC.  
TELEPHONE SERVICE: VERIZON SOUTHWEST  
WATER: INDIVIDUAL WELLS  
WASTEWATER: INDIVIDUAL ON-SITE SEPTIC SYSTEM

OWNERS: MARK L. AND CARYLE R. GLOSSER  
6417 DARLINGTON ROAD  
PITTSBURG, PA. 15217

SURVEYOR: WILL PERRIN R.P.L.S.  
101 VESPER LANE  
WIMBERLEY, TEXAS 78676

**REPLAT OF**  
OF  
**LOT 1 AND LOT 2**  
NORRIS RANCH ESTATES  
A SUBDIVISION RECORDED IN  
VOLUME 8, PAGE 87,  
PLAT RECORDS OF  
HAYS COUNTY, TEXAS