

DATE	4-11-05	BY	DAI
PROJECT	4-11-05	BY	DAI
NO.	1-05-001	REV.	1

G. B. Moore  
Survey No. 2  
Abstract No. 771

1666 Acres  
Vol. 166 Pg. 147

Loretta D. Lowe &  
Larry K. Lowe Survey  
Abstract No. 839

214.42 Acres  
Vol. 2426 Pg. 397

214.42  
Acres

Abner Smalley Sur. No. 443  
L. W. Kingsley Sur. No. 414

T. F. Martin  
Survey

Mays County Road  
No. 187  
McGregor Lane

5432 Acres  
Vol. 1005 Pg. 675

233.18 Acres  
Vol. 1062 Pg. 544

12.77 Acres  
Vol. 1940 Pg. 170

4.18 Acres  
Vol. 1384 Pg. 138

6.01 Acres  
Doc. No.  
2007701

Lot 1  
Penn Subdivision  
Blk 5 - Pg. 209

U. S. Highway No. 290

A legal description of some date was prepared for the tract of land shown hereon.  
This plat was prepared from an on the ground survey performed under my direction and supervision.

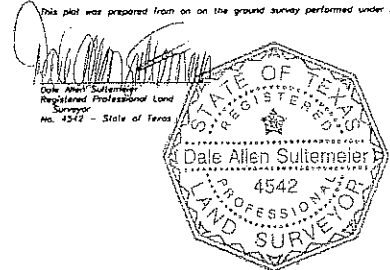

331.05

LEGEND  
 ○ monument, found unless noted otherwise  
 \* 400' not found  
 # 1/2" inch iron rod found  
 □ concrete R.G.M. monument found  
 --- city fence line

LINE	BEARING	LENGTH
17	S 27° 51' 11" E	132.00
18	S 22° 30' 24" W	134.00

BLK	SECTION	RANGE	COUNTY	STATE	ACRES
01	17-18	22E-23E	107E-20E	114E-12E	6,428.72
02	22E-24E	17E-19E	22E-23E	114E-12E	6,428.72



**SULTEMEIER SURVEYING**  
304 East Main - Johnson City, Texas  
(830) 868-7308 78636

PLAT SHOWING A 214.42 ACRE TRACT OF LAND WHICH  
COMPRISES PORTIONS OF SURVEYS ( AND POSSIBLE VACANT  
LAND) IN HAYS COUNTY, TEXAS.